

M40
X=4589431.64
Y=5609661.02

W12
X=4589503.76
Y=5609631.72

W13
X=4589642.28
Y=5609576.81

POCZĄTEK OPRACOWANIA: 0+000.00

0+207.87 kanieć rowu



W13
X=4589642.28
Y=5609576.81

W14
X=4589837.64
Y=5609496.22

W15
X=4589984.13
Y=5609437.11

REZYGNUJE SIĘ Z RÓWU OD 0+107,81
DO 0+52,00, Z PRZEOSTO NR 17,
18, 19.

A. Kasu

MGR INŻ. STANISŁAW CHOŃSKI
uprawnienia inż. (Prac. Budowlanego
w zakresie plan. i bud. dróg i mostów
Nr K B U la - 2126/164/65

inż. Andrzej Dąbrowski
upr. bud. drogowego nr 275/66
- bez ograniczeń -

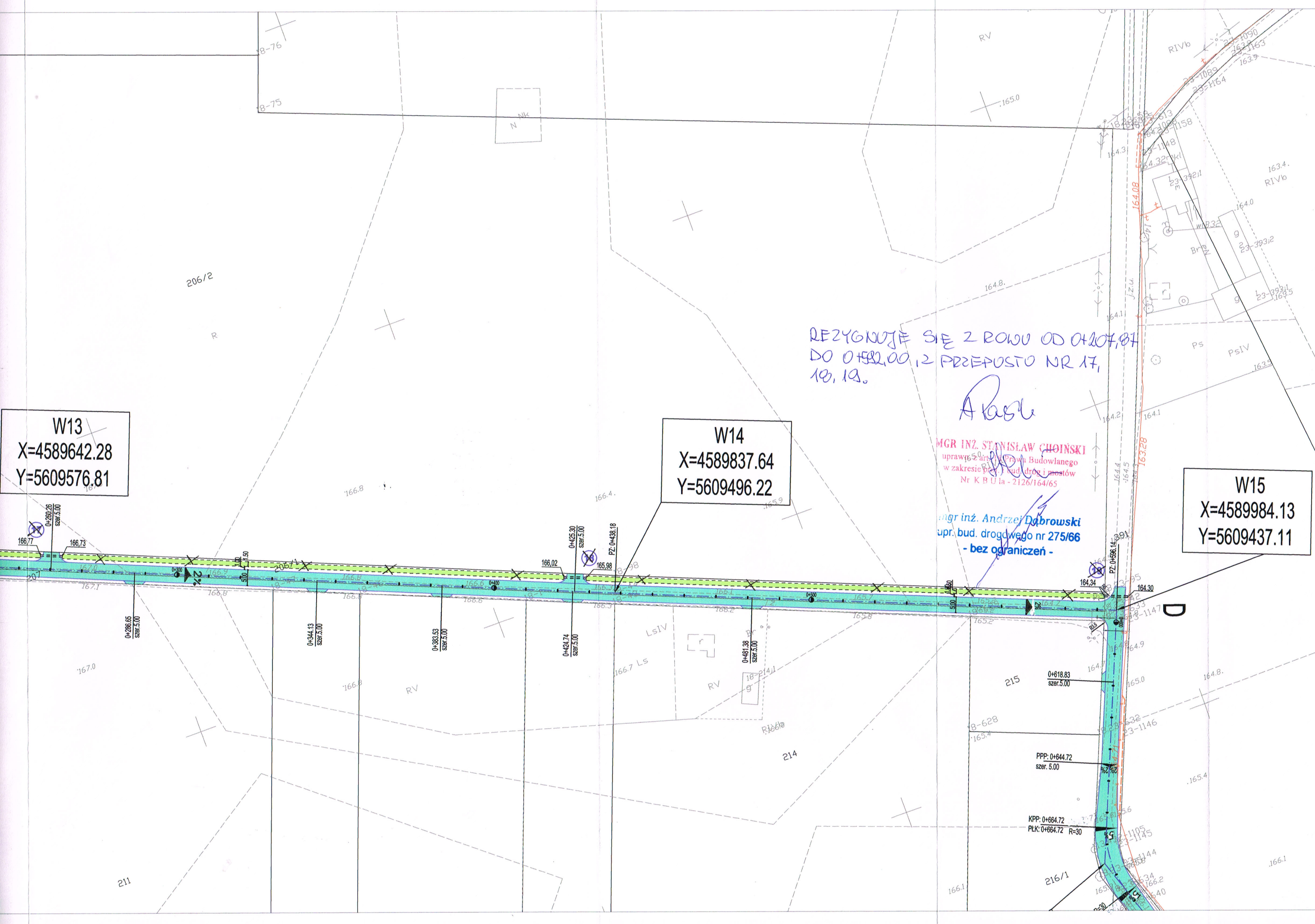

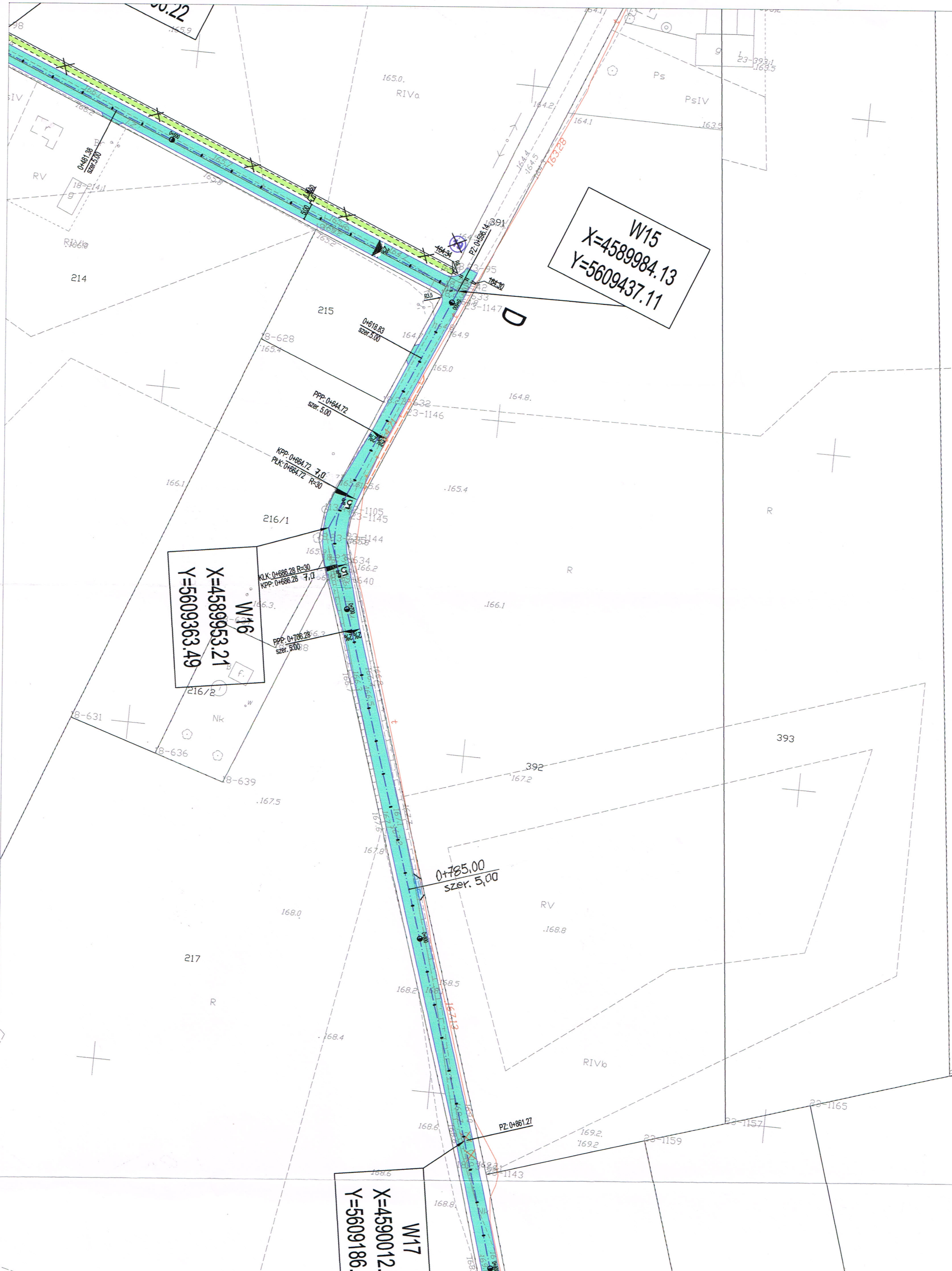

W17
X=4590012.00
Y=5609186.75

W18
X=4590042.48
Y=5609087.39

W19
X=4590068.69
Y=5609003.80



Wala Pekoszewska
obr.

418

417

.169.7

.170.4

.171.0

172.2

172.3

172.4

173.0

RIVa

R 174.2

174.1

437

175.0

174.9

438

Br

Br

Br

Br

Br

Br

Br

Br

Br

Br

218

168.9

.170.0

172.0

171.9

171.0

171.9

172.0

172.0

172.0

172.0

172.0

172.0

172.0

172.0

172.0

172.0

172.0

172.0

172.0

172.0

172.0

172.0

172.0

172.0

172.0

172.0

172.0

172.0

172.0

172.0

172.0

172.0

172.0

172.0

172.0

172.0

172.0

172.0

172.0

172.0

172.0

172.0

172.0

172.0

172.0

172.0

172.0

172.0

172.0

172.0

172.0

172.0

172.0

172.0

172.0

172.0

172.0

172.0

172.0

172.0

172.0

172.0

172.0

172.0

172.0

172.0

172.0

172.0

172.0

172.0

172.0

172.0

172.0

172.0

172.0

172.0

172.0

172.0

172.0

172.0

172.0

172.0

172.0

172.0

172.0

172.0

172.0

172.0

172.0

172.0

172.0

172.0

172.0

172.0

172.0

172.0

172.0

172.0

172.0

172.0

172.0

172.0

172.0

172.0

172.0

172.0

172.0

172.0

172.0

172.0

172.0

172.0

172.0

172.0

172.0

172.0

172.0

172.0

172.0

172.0

172.0

172.0

172.0

172.0

172.0

172.0

172.0

172.0

172.0

172.0

172.0

172.0

172.0

172.0

172.0

172.0

172.0

172.0

172.0

172.0

172.0

172.0

172.0

172.0

172.0

172.0

172.0

172.0

172.0

172.0

172.0

172.0

172.0

172.0

172.0

172.0

172.0

172.0

172.0

172.0

172.0

172.0

172.0

172.0

172.0

172.0

172.0

172.0

172.0

172.0

172.0

172.0

172.0

172.0

172.0

172.0

172.0

172.0

172.0

172.0

172.0

172.0

172.0

172.0

172.0

172.0

172.0

172.0

172.0

172.0

172.0

172.0